

AGM29 12V 90Ah

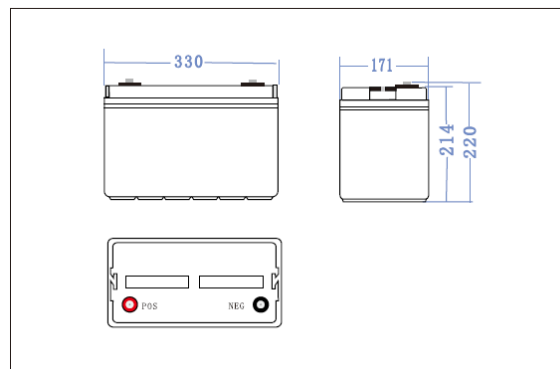

Dimensions (mm)



Terminal Type

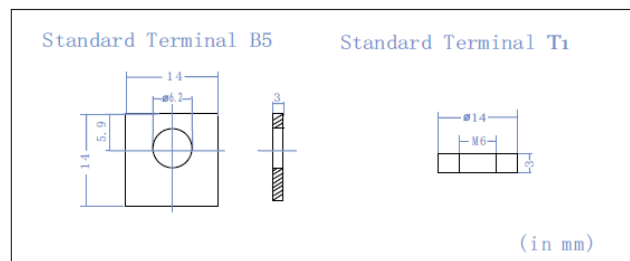

Electrical Specification

Capacity 25°C (77° F)	10hour rate (9A)	90.0Ah
	5 hour rate (15.3A)	78.3Ah
	1 hour rate (49.5A)	54.0Ah
Capacity Affected by Temperature (20hour rate)	40°C (104° F)	102%
	25°C (77° F)	100%
	0°C (32° F)	85%
Internal Resistance	Full charged battery 77° F (25°C)	8.5mΩ
	Self-Discharge at 25°C (77° F)	
Charge (constant Voltage)	Cycle	Initial Charging Current less than 22.5A Voltage 14.40-14.90V
	Float	Voltage 13.50-13.80V

Physical specification

Nominal Voltage	12V	
Nominal Capacity (10HR)	90AH	
Dimensions	Length	330±1mm (13.0 inches)
	Width	171±1mm (6.73 inches)
	Container Height	214±2mm (8.43 inches)
	Total height	224±2mm (8.82 inches)
Weight	Approx 26.5kg (58.3 lbs)	
Standard Terminal	B5/T1	

Cycle service life in relation to depth of discharge

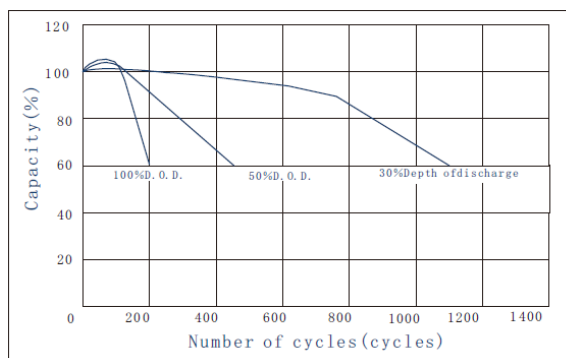

Discharge Characteristics after fully charged (25°C, 77°F)

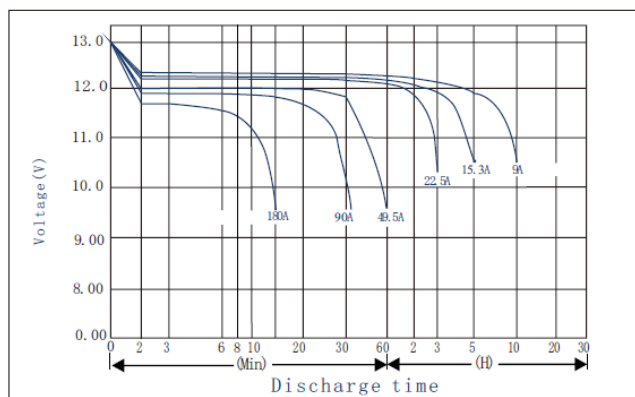

Constant Current (Amp) and Constant Power (watt) Discharge Table at 25°C, (77°F)

time		10min	15min	30min	1h	2h	3h	4h	5h	8h	10h	20h
9.60V	A	189	149	90.0	55.8	32.9	23.0	18.8	16.0	11.0	9.2	4.8
	W	2020	1623	1004	633	379	268	221	189	130	108.5	57.5
9.90V	A	183.6	144.9	88.2	55.0	32.7	22.9	18.7	15.9	11.0	9.2	4.8
	W	1970	1590	987	625	377	267	220	188	130	108.9	57.5
10.20V	A	176	140	85.5	53.6	32.4	22.7	18.5	15.8	10.9	9.1	4.8
	W	1890	1536	960	611	375	265	218	187	129	108.0	57.4
10.50V	A	168	135	83.4	52.2	32.0	22.5	18.5	15.8	10.8	9.1	4.8
	W	1818	1492	940	598	371	264	218	187	128	108.0	57.1
10.80V	A	158	128	80.4	50.9	31.1	21.9	17.9	15.3	10.4	9.0	4.7
	W	1715	1417	909	584	362	257	212	182	124	107.1	56.7